

Instructions for Models:

S-2550

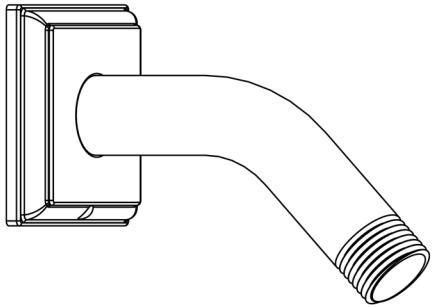

Need Help?

For additional assistance or service call:

SPEAKMAN Company
400 Anchor Mill Road
New Castle, DE 19720

PHONE: 800-537-2107
EMAIL: customerservice@speakmancompany.com
WEB: www.speakmancompany.com

92-3327-R1

What You Need To Know:

Tools:

Required:

*Teflon Tape



*Allen Wrench
(supplied)

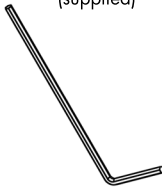

Important Notes:

Be sure to read instructions thoroughly before beginning installation. Do not overtighten any connections or damage may occur.

Safety Tips:

Cover your drain to prevent loss of parts.

Maintenance:

Your new Shower Arm is designed for years of trouble-free performance. Keep it looking new by cleaning it periodically with a soft cloth. Avoid abrasive cleaners, steel wool, and harsh chemicals as these will dull the finish and void your warranty.

① Apply Teflon Tape to inlet side of shower arm.

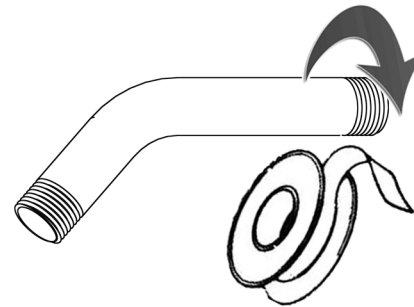

② Thread Shower Arm into Female Pipe Fitting within the wall. Firmly tighten, and make sure Shower Arm Outlet is pointing in a downward position.

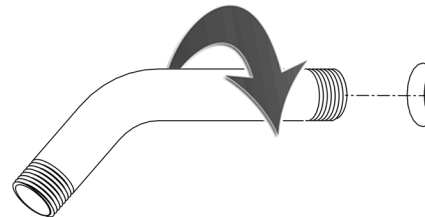

③ Slide Escutcheon Plate over Shower Arm and position flat against wall. Secure Escutcheon Plate to Shower Arm by tightening set screw with supplied Allen Wrench.

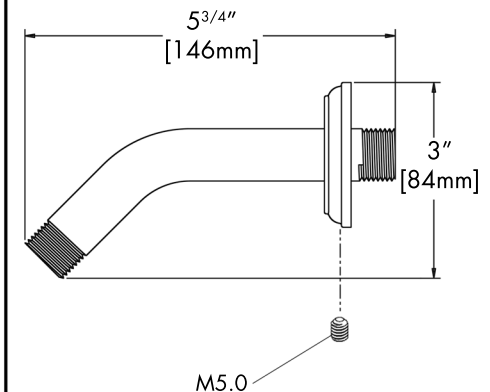
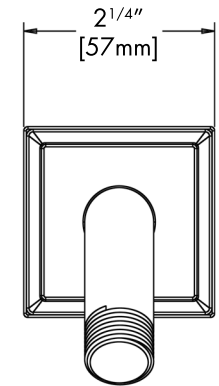
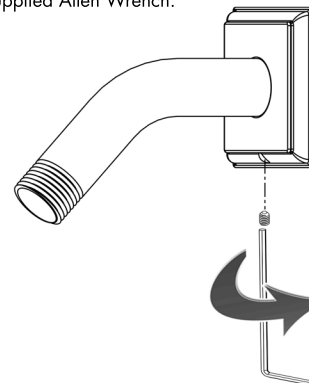

Specifications:

Supply Inlet: 1/2" NPT MALE
Outlet: 1/2" NPT MALE